Prasanna Kumar Ganes
Geotechnical Engineer

I HAVE REVIEWED / CHECKED THE STRUCTURAL DRAWING AND DESIGN DETAILS OF THIS PROJECT WHICH HAS BEEN DONE COMPLYING RELEVANT IS CODE INCLUDING SEISMIC AND THE NATIONAL BUILDING CODE.I CERTIFY THAT THE STRUCTURE WILL BE SAFE & STABLE AGAINST ALL VERTICAL AND LATERAL LOADS AND WILL BE FIT FOR HABITABLE USE.

Utpal Sarmah

UTPAL SANTRA
B. C. E. M. C. E. (STRUCT)
F. I. E.-F1212601

SIGN. OF STRUCTURAL REVIEWER
UTPAL SANTRA (ESR-(1)58/10)

THE STRUCTURAL DESIGN & DRAWING OF BOTH FOUNDATION & SUPER-STRUCTURE OF THE BUILDING AT PREMISES NO. 260 MOTILAL GUPTA ROAD, KOLKATA 700008, WARD NO.122, BOUGHOU NO.XI/PS. BEHALA HAVE BEEN MADE BY ME CONSIDERING ALL THE POSSIBLE LOADS INCLUDING THE SEISMIC LOAD AS PER THE NATIONAL BUILDING CODE OF INDIA & CERTIFIED THAT IT IS SAFE & STABLE IN ALL RESPECTS. TESTING REPORT HAS BEEN DONE BY MR.PRASANTA KUMAR GHOSH OF "GEOCON" THE RECOMMENDATION OF SOIL TEST REPORT HAS CONSIDERED DURING STRUCTURAL CALCULATION.

Ankit Agarwal
ANKIT AGARWALA
B.E., CIVIL ENGINEERING
CIVIL ENGINEERING, E.I.T.M.P.O.
MADRAS UNIVERSITY, CHENNAI-600 075.

SIGN. OF STRUCTURAL ENGINEER
ANKIT AGARWALA (ESE.I/172

[illegible]

Mertlin Projects Ltd.
Mertlin
SIGN OFF OFFICER
RABINDRA JHA
AUTHORISED SIGNATORY
OF MERTLIN PROJECTS LTD.
FOR PVC WIRES & CABLE
PVT. LTD. &
OTHERS 81 COMPANY

1 CEMENTED WITH FULL RESPONSIBILITY THAT THE BUILDING PLAN HAS BEEN DRAWN AS PER PROVISION OF K.M.C
2 BUILDING RULES 2009 AS AMENDED FROM TIME TO TIME AND THE SITE CONDITIONS INCLUDING WIDTH OF THE
3 ADJUTING ROAD (10.10 M) CONFORMS WITH THE PLAN. THE LAND IS BEING MEASURED & VERIFIED BY ME. IT IS A
4 BUILDABLE SITE NOT A TANK OR FILLED UP TANK. THE LAND IS DEMARCATED BOUNDARY WALL THE CONSTRUCTION OF
5 U.C. WATER TANK AND SEPTIC TANK WILL BE COMPLETED BEFORE STARTING OF BUILDING FOUNDATION WORK.

Sd/- *K. R. Basu*
SIGN. OF ARCHITECT
SUBIR KUMAR BASU
(C.A./78/4375

PROPOSED, 4 NO. G+20 STORED (65 m.), 1 NO. G+18 STORED, (58.9 m.), 1 NO. B+G+4P+16 STORED (65 m.), AND 4 STORED ASSEMBLY (18,850 m.) BUILDING IN RESIDENTIAL COMPLEX AT 266 MORTUARY GUPA ROAD, KOLKATA - 700008, WARD NO.- 122 BOROUGH NO.- XIII, P.S.- BEHALA.)

SHEET TITLE - STP & UGWR

ARCHITECT

Subir Kumar Basu
CONSULTING ARCHITECTS

RS

4, BROAD STREET
KOLKATA-700019

DEALT BY: S.DASGUPTA	SCALE: 1:300	DRAWING NO. SKB/M/KM/CAR/ ESKT /AO/27	SHEET NO. 27 OF 30	REV. 0
CHECKED BY: T.K.SAHA	SHEET: A0		DATE : 28/04/2022	

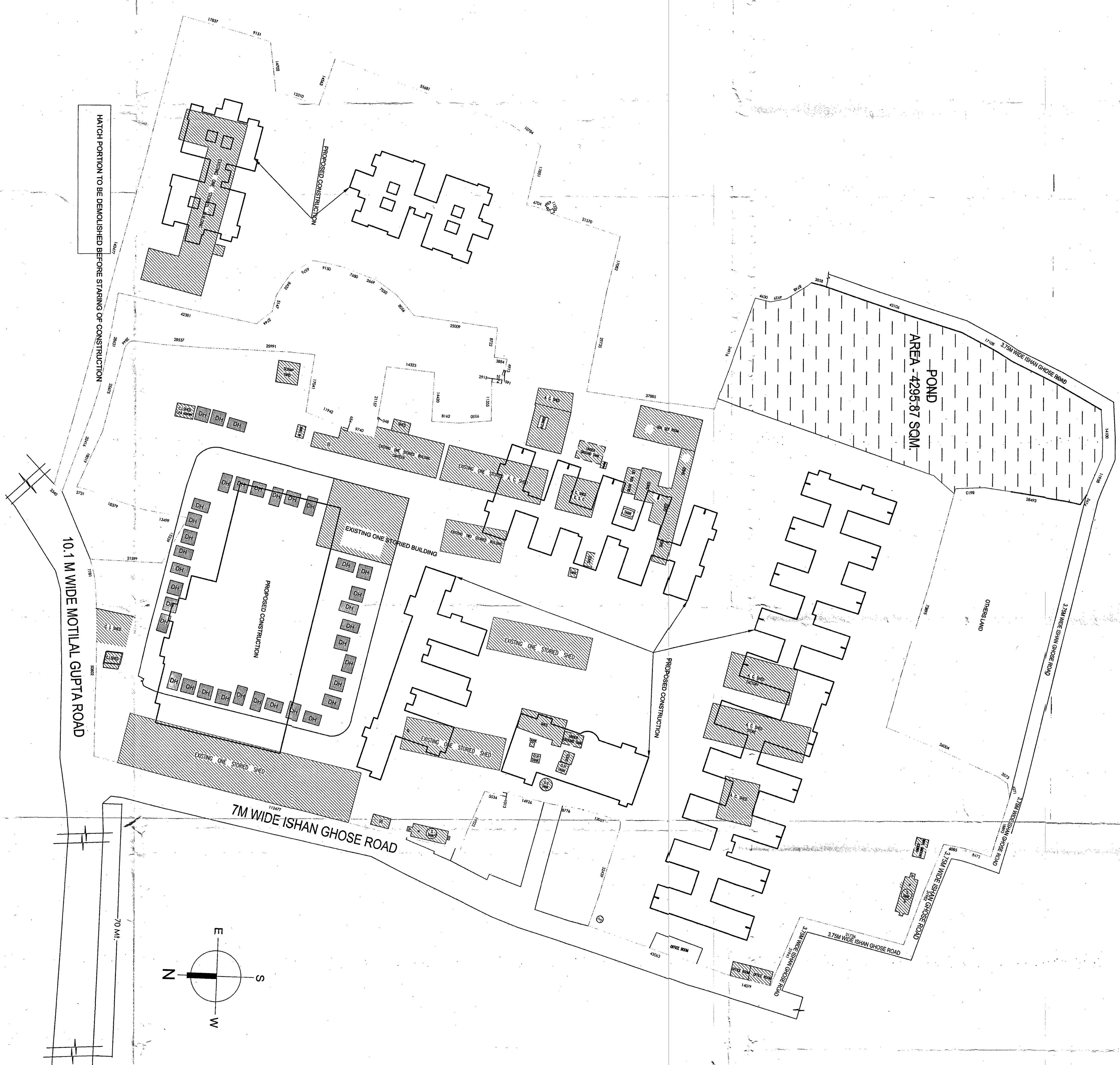

EXISTING PLAN
SCALE - 1:200

Approved by M.B.C.
dt...../4/2/2022..

Standard subject to revision
of existing structure to provide
open space as per plan below
@
Emerson Engineering is limited
By: Mr. X.Y.Z. Date: 12/11/17

APPROVED
By: (Signature)
ASSISTANT ENGINEER (C)
BOROUGH INC.

THE SANCTION IS WALD
UP TO.....5/12/2027

THE KARNATAKA ENGINEERING
REGULATIONS, 1987
Under the provisions of
Section 14, the Engineer
@
Emerson Engineering is
not liable for the work.

(2)



DEVIATION WOULD MEAN DEVOLUTION

CONSTRUCTION SITE SHALL BE MAINTAINED TO PREVENT MOSQUITO BREEDING AS REQUIRED U/S 496(1) & (2) OF CMC ACT 1980, IN SUCH MANNER SO THAT ALL WATER COLLECTIONS PARTICULARLY LAKE, WELLS, VATS, BASEMENT SURING SITES OPEN RECEPTACLES ETO AS EMPTIED COMPLETELY TWICE & WEAR

No rain water pipe should be fixed or discharged on Road or Footpath. Drainage plan should be submitted at the Borough Executive Engineer's Office and the sanction obtained before proceeding with the drainage work

Before starting any Construction the site must conform with plans sanctioned and all the conditions as proposed in the plan should be fulfilled

The validity of the written permission to execute the work is subject to the above conditions

A suitable pump has to be provided i.e. pumping unfiltered water for the distribution to the flushing cisterns and urinals in the building incase unfiltered water from stream main is not available

deviation may lead to disconnection/demolition

CONSTRUCTION SITE SHALL BE MAINTAINED FREE FROM AIR POLLUTION ACCORDING TO UNDERTAKING SUBMITTALS AS PER AMENDMENT DT. 31.01.2019 /IDE NO. 95/MA/00C/3R-7/2017 OF SCHEDULE-IV OF KMC BUILDING RULE 2003

**Non Commencement of Erection/
Re-Erection within Five year will
Require Fresh Application for Sanction**

All Building Materials to necessary & construction should conform's to standerd specified in the National Building Code of India.

Design of all Structural Members including that of the foundation should conform to Standards specified - the National Building Code of India.

CHECKED AND UNIFIED
A.E.(G)/R.A.E.(G)

Fresh Don
Amoritas



Necessary steps should be taken for the safety of the lives of the adjoining public and private properties during construction.

Structure _____, sign calculation as submitted by the structure engineer, has been kept with B. P. No. _____, Date _____, for record of the County _____ Corporation without violation No. _____, deviation from No. _____, without structural plan being made at the time of recording, without submitting fresh structural plan along with design calculation and stability certificate in the hands of the Engineer, No. _____, stamps should be taken for the safety of the building premises public and private properties and safety of the life during construction.

A. Polamack
Asst. Engineer/Technical Officer / Executive Engineer
BOROUDH RD. XIII, XIV